



# MODEL TR2273

## CREEP DRIVE GEARBOX

### Product Description:

Model TR2273 is an auxiliary gearbox designed to provide precision vehicle speed control by using a hydraulic motor to rotate the vehicle drive shaft. The Creep Drive gearbox is installed in the drive-line between the main transmission and rear axle. In road mode power is transmitted normally via a through shaft in the gearbox. In creep mode the main transmission is shifted to neutral and the hydraulic motor and reduction gear-set in the gearbox are engaged to rotate the drive-line. Applications include paint-striper, feeders, spreaders, lifts, road/rail, and similar uses requiring precise speed control, inching, or remote operation.

<b>NOMINAL APPLICATION POWER:</b>	450 HP
<b>MAX INPUT SPEED:</b>	3000 RPM Drive shaft 500 RPM Motor pad.
<b>TORQUE CAPACITY:</b>	Drive shaft - 12,500 lb-ft. Motor pad - 1250 lb-ft
<b>REDUCTION RATIO:</b>	3:1 gearbox 13.5:1 using optional 4.5:1 input planetary
<b>MOTOR/PUMP PAD:</b>	SAE "C" SAE "D" with optional planetary gearbox
<b>THROUGH SHAFT SPLINE SIZE:</b>	2.75 X 10 Straight side
<b>MOUNTING:</b>	(4) 3/4"-10 tapped holes on 11"X13" rectangular pattern
<b>LUBRICATION:</b>	Internal reservoir. Splash delivery
<b>SHIFTING:</b>	Dual acting air cylinder
<b>WEIGHT:</b>	Approximately 400 lbs.

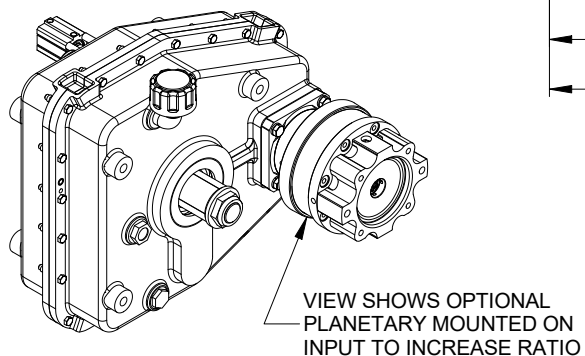
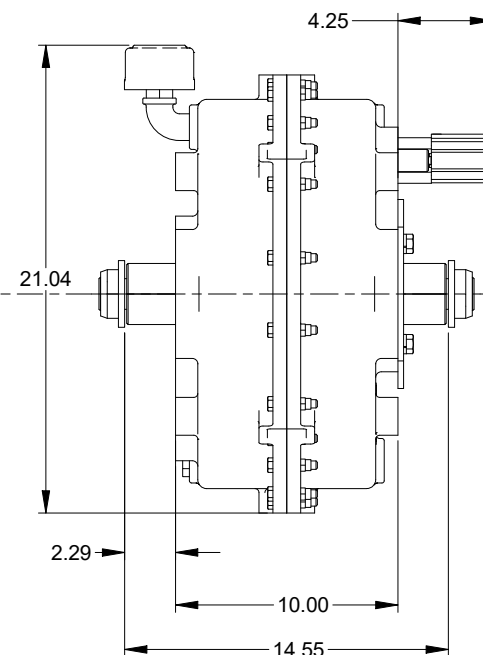
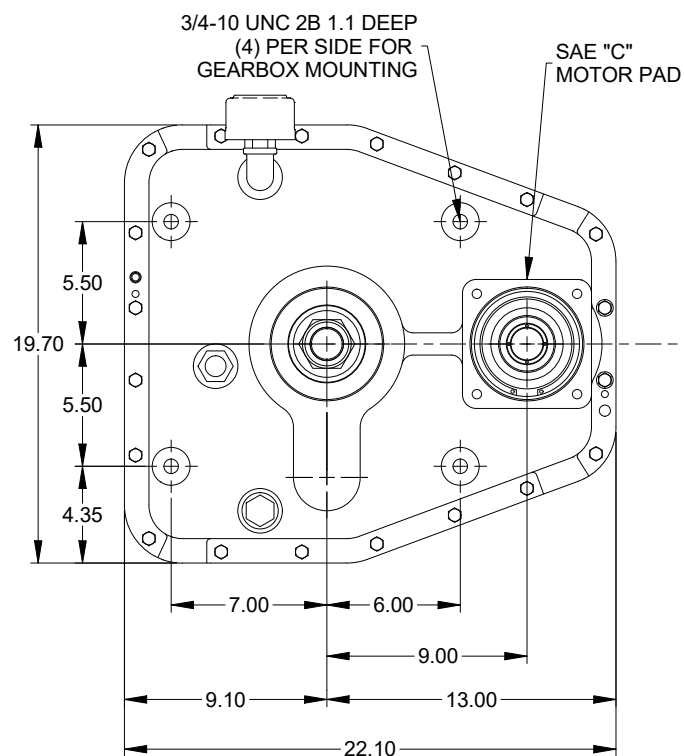
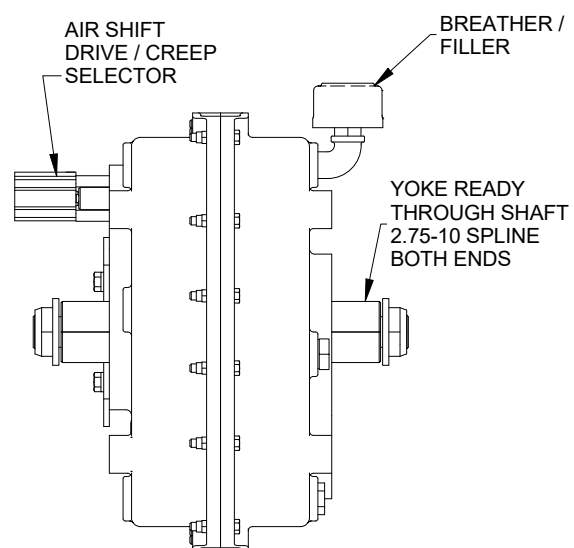

**TR2273 DRW.**