



MODEL SN2265

4 SQUARE HEADSTOCK GEARBOX

Product Description:

Model SN2265 is a foot mounted headstock gearbox used with model SN2264 to comprise a 4-square test system. This gearbox interfaces with the drive motor and hosts the torque actuator.

POWER:	7500 lb-ft max torque at either shaft 200 HP max in torque loop
OUTPUT SPEED:	1385 RPM at either shaft
RATIOS:	1:1
MAX ACCEL / DECEL RATE:	2000 RPM / sec at output
INPUT CONFIGURATION:	Keyed stub shaft is standard. Contact Cotta for options.
OUTPUT CONFIGURATION:	Keyed stub shaft is standard. Contact Cotta for options.
ROTATION:	Input can be driven ccw or cw. Both shafts rotate in the same direction.
LUBRICATION:	Positive delivery. Pump, heat exchanger, and necessary temp and pressure controls are furnished.
OPTIONS:	Accelerometers, speed pickup, and other application specific items can be accommodated or supplied.
APPROXIMATE WEIGHT:	3100 lbs.
STANDARD FINISH:	2-part polyurethane enamel



This drawing shows general arrangement and approximate space claim. Do not design, scale, or lay out using this drawing. Use only certified drawings provided by Cotta Engineering.

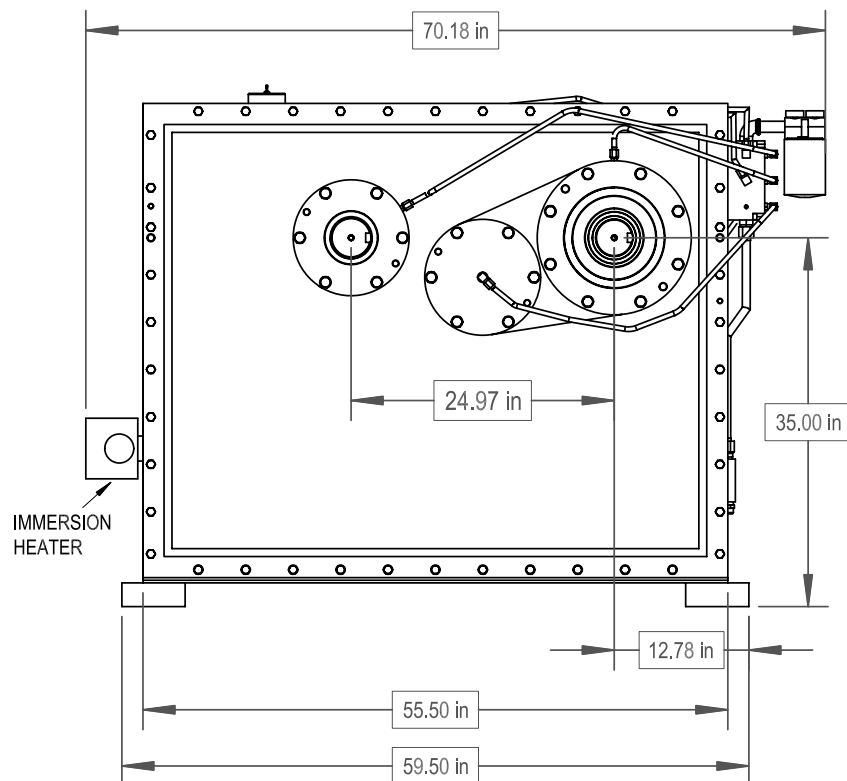

Note: this gearbox is used with SN2264 Tailstock Gearbox to comprise a 4-square system. Contact Cotta to discuss specific application details.

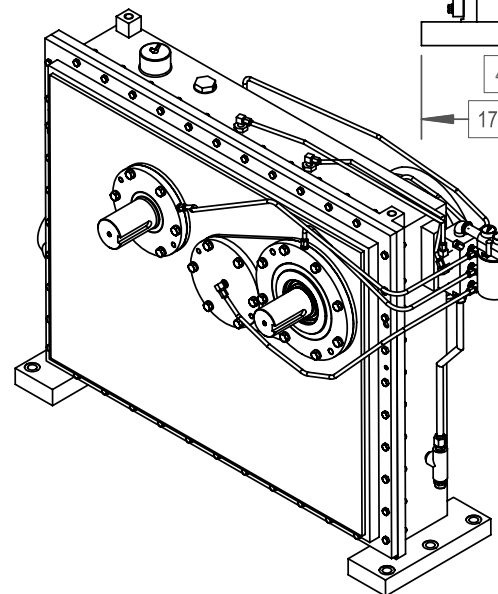
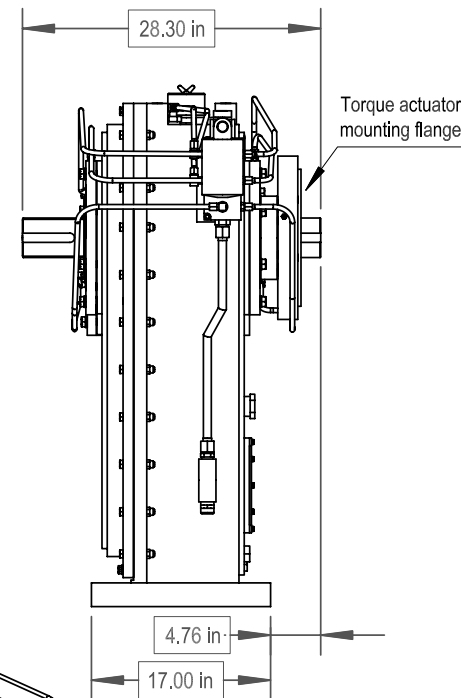

SN2265 DRW.