



MODEL SN1903 HIGH SPEED GEARBOX

Product Description:

Model SN1903 is a foot mounted, two stage increasing, single output, high speed gearbox designed for test stand use. The gearbox output is vertically offset at 12:00 o'clock to the input.

POWER:	600 HP nominal
OUTPUT SPEED:	30,000 RPM
RATIOS:	Up to 16.55 overspeed. Contact Cotta for common ratios.
MAX ACCEL / DECEL RATE:	2000 rpm/sec at output. For higher rates contact Cotta.
INPUT CONFIGURATION:	Stub shaft is standard. Contact Cotta for optional inputs.
OUTPUT CONFIGURATION:	Aerospace accessory mounting pad AND20006 is typical. Various other pads and shafting options available.
ROTATION:	Input can be driven ccw or cw. Output rotates in the same direction as input.
LUBRICATION:	Positive delivery. Pump, heat exchanger, and necessary temp and pressure controls are furnished.
OPTIONS:	Accelerometers, speed pickup, and other application specific items can be accommodated or supplied.
APPROXIMATE WEIGHT:	1600 lbs.
STANDARD FINISH:	2-part polyurethane enamel

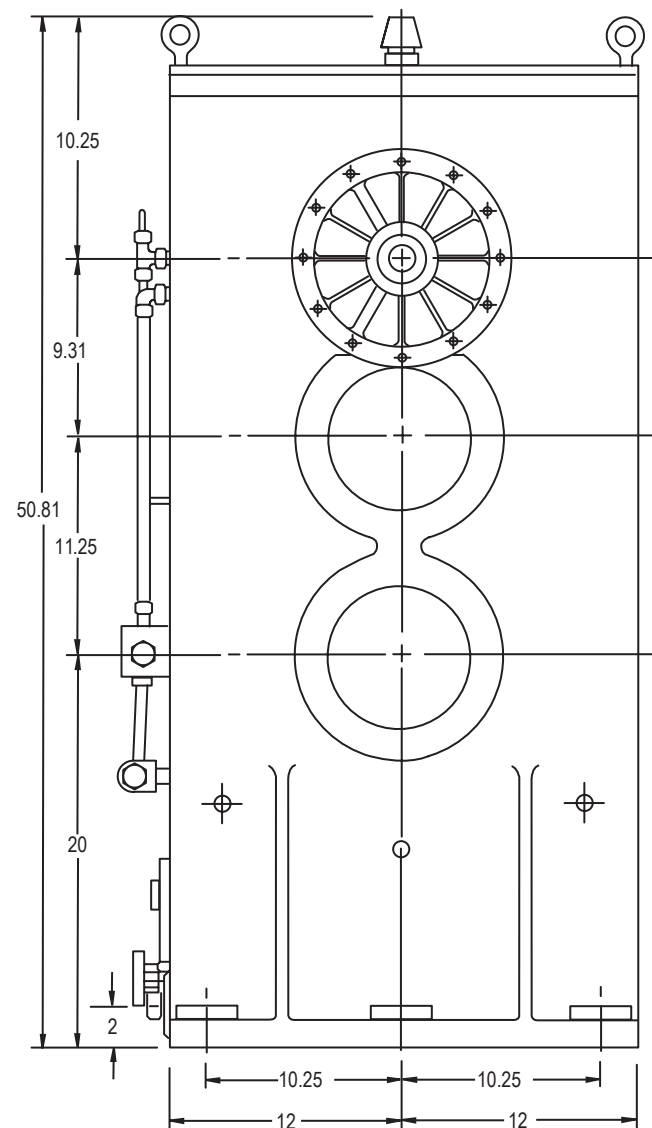
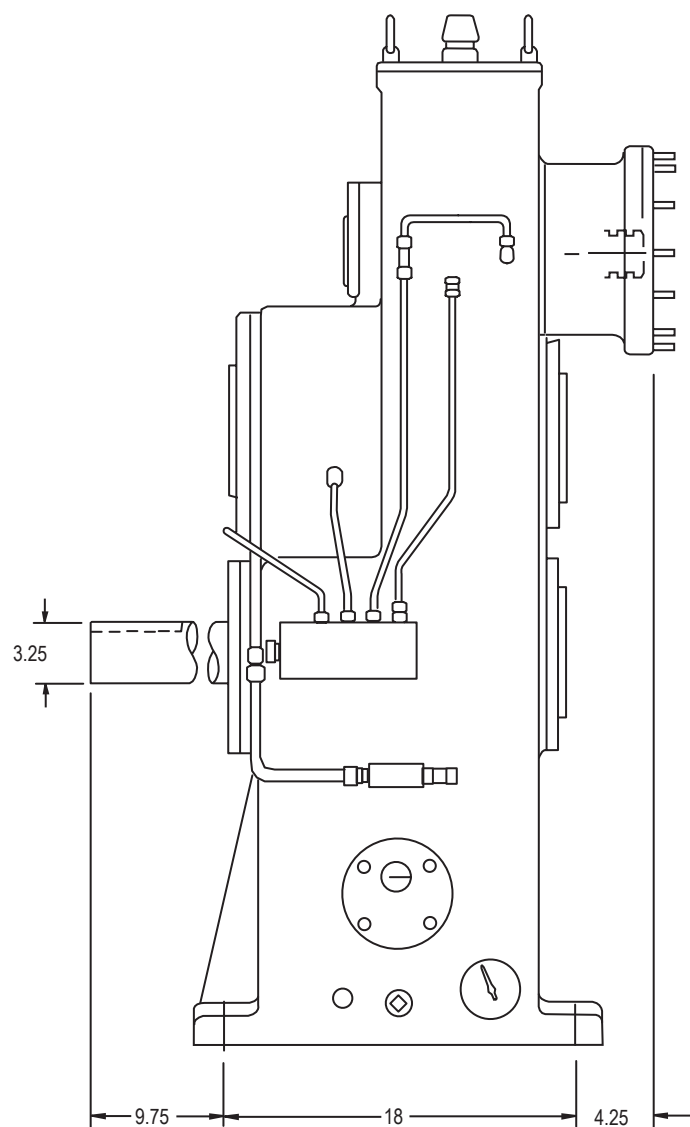

SN1903 DRW.